



Separadores con rosca pasante Thru-Hole Threaded Standoffs

ACERO
STEEL

INOX
ST. STEEL

ALUMINIO
ALUMINIUM



Tipo Type	Material Material	Acabado Finished	Uso Working
STO STO	ACERO AL CARBONO CARBON STEEL	CINCADO ZINC PLATED	≤ 80 HRB ≤ 80 HRB
A2O A2O	ACERO INOX. SERIE 303 303 STAINLESS STEEL	PASIVADO ASTM A380 PASIVATED ASTM A380	≤ 70 HRB ≤ 70 HRB
ALO ALO	ALUMINIO 7075-T6 7075-T6 ALUMINIUM	PULIDO POLISHED	≤ 50 HRB ≤ 50 HRB

ROSCA / THREAD: 6g ISO Metric

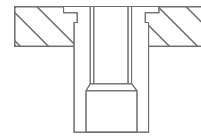
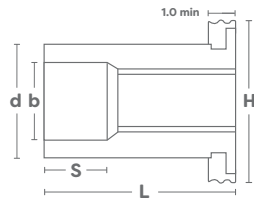

Código Code
*xx = L
Ejemplo/Example: 04M0306STO

THREAD	Código Code			L mm.	mm.	min mm.	min. mm.	d mm.	b mm.	S mm.	H mm.	
	Acero Carb. Cinc. Carbon Steel	Acero Inox. St. Steel	Aluminio Aluminium									
M3 x0,5	04M03xxSTO	04M03xxA2O	04M03xxALO	3-4-6-8	4,2	6,0	1,0	4,19	3,2	none	4,8	2.000
				10-12-14								
				16-18								
3.5M3 x0,5	04M3503xxSTO	04M3503xxA2O	04M3503xxALO	3-4-6-8	5,4	7,0	1,0	5,38	3,2	none	6,4	2.000
				10-12-14								
				16-18								
M4 x0,7	04M04xxSTO	04M04xxA2O	04M04xxALO	3-4-6-8	7,2	8,0	1,3	7,11	4,8	none	7,9	1.000
				10-12-14								
				16-18-20-22-25								
M5 x0,8	04M05xxSTO	04M05xxA2O	04M05xxALO	3-4-6-8	7,2	8,0	1,3	7,11	5,35	none	7,9	1.000
				10-12-14								
				16-18-20								
				22-25								